

UWANT

# V100 Cordless Vacuum Cleaner Instruction Manual

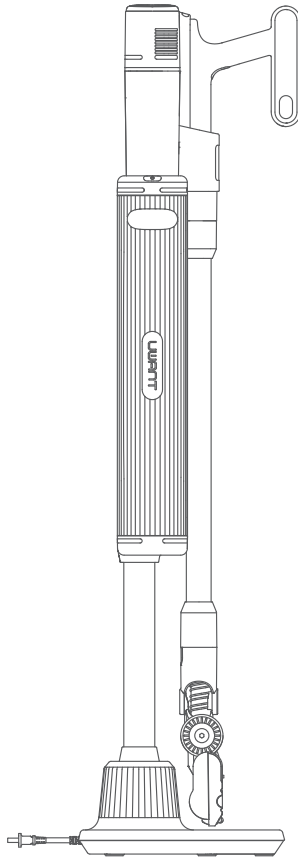

Please read this manual carefully prior to use and retain it properly.



Dear user:

Thank you for using the cordless vacuum cleaner. This manual is suitable for model V100. The contents described in the manual are only for the user's reference during use and maintenance. For matters not covered, please consult the customer service department of our company.

Precautions-----	01
Product Introduction-----	02
Instructions for Use-----	04
Maintenance -----	08
Troubleshooting -----	11
Specifications -----	11
Schematic Circuit Diagram -----	12
Name and Content of Hazardous Substances -----	13

 Please read this instruction manual carefully and keep it for future reference.

- This product is an electric appliance. Do not let it run alone without supervision. If you do not use this product for a long time, please remove the battery pack;
- The machine must be turned off when cleaning, servicing or temporarily not in use;
- Do not use the machine to inhale heating objects such as carbon, cigarette buttsharp objects such as broken glass pieces, corrosive liquids, gasoline, alcoholand other flammable and explosive materials, or it may damage the machine orcause a fire, resulting in accidents such as personal injury;
- Do not use this product to absorb water or damp dust, and avoid it being exposed to rain, water, or used in humid places (such as bathrooms, toilets, laundryrooms, etc.) to avoid alfunctions;
- Avoid approaching heat-generating appliances or exposure to the sun to avoid-fire;
- Do not let children play and operate the machine to avoid accidents;
- Avoid running for a long time with the suction port blocked, so as not to damage the machine;
- Do not sit on this product to avoid damage to the machine;
- Do not remove the roller brush assembly when the machine is running to avoid-personal injury;
- Only qualified technical personnel is allowed to disassemble, repair, or modify;
- Please regularly check the smoothness of the elbow of the filoor brush, If there is any blockage, please use the cleaning tool to clean it up in time to avoid the-blockage that will cause the suction to drop and affect the service life of the machine;
- The technology and data in this product manual are obtained by the company or a designated third-party testing agency. We reserve the right of final interpretation;
- This appliance is not intended for use by persons(including children) with reduced physical, sensory or mental capabilities, or lack of experience and knowledge,unless they have been given supervision or instruction concerning use of the appliance by a person responsible for their safety;
- This appliance can be used by children aged from 8 years and above and persons with reduced physical, sensory or mental capabilities or lack of experience and knowledge if they have been given supervision or instruction concerning use of the appliancein a safe way and understand the hazardsinvolved. Children shall not play with the appliance, Cleaning and user maintenance shall not be made by children without supervision;
- Chidren should be supervised to ensure that they do not play with the appli-



ance;

- Only use the detachable supply unit (model: JWV100-J-A) provided with this appliance;
- **WARNING:** For the purposes of recharging the battery, only use the detachable supply unit provided with this appliance;
- If a vacuum cleaner can be equipped with a hand-held accessory with rotating parts a warning has to be given concerning entrapment; The plug must be removed from the socket-outlet before cleaning or maintaining the appliance;
- Hazardous to the environment shall give details on how to remove the battery and shall state that;
  - a. the battery must be removed from the appliance before it is scrapped;
  - b. the appliance must be disconnected from the supply mains when removing the battery;
  - c. the battery is to be disposed of safely.

II

## Product Introduction

### • Part Name

⚠ **Note:** The pictures in the manual are for reference only. Please refer to the actual product for details.

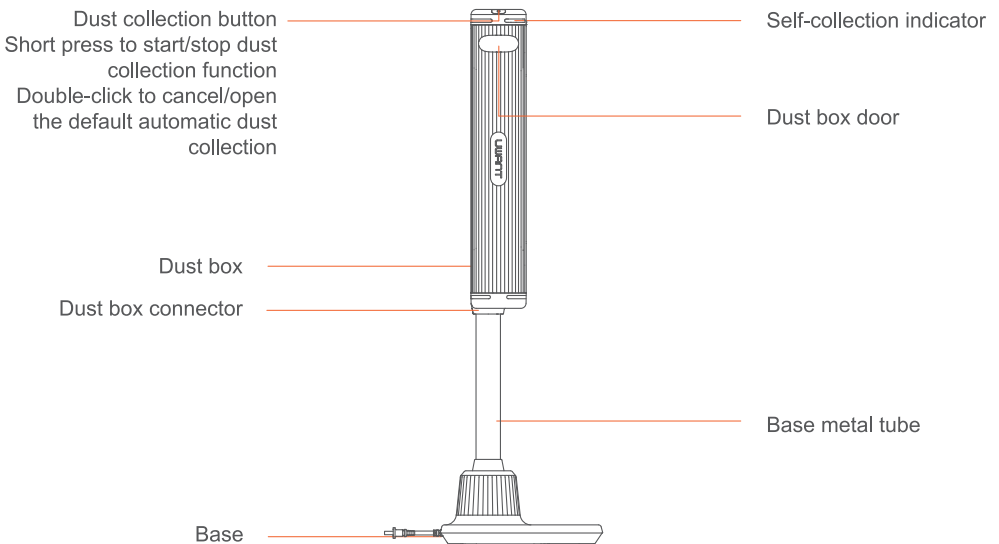

① Base

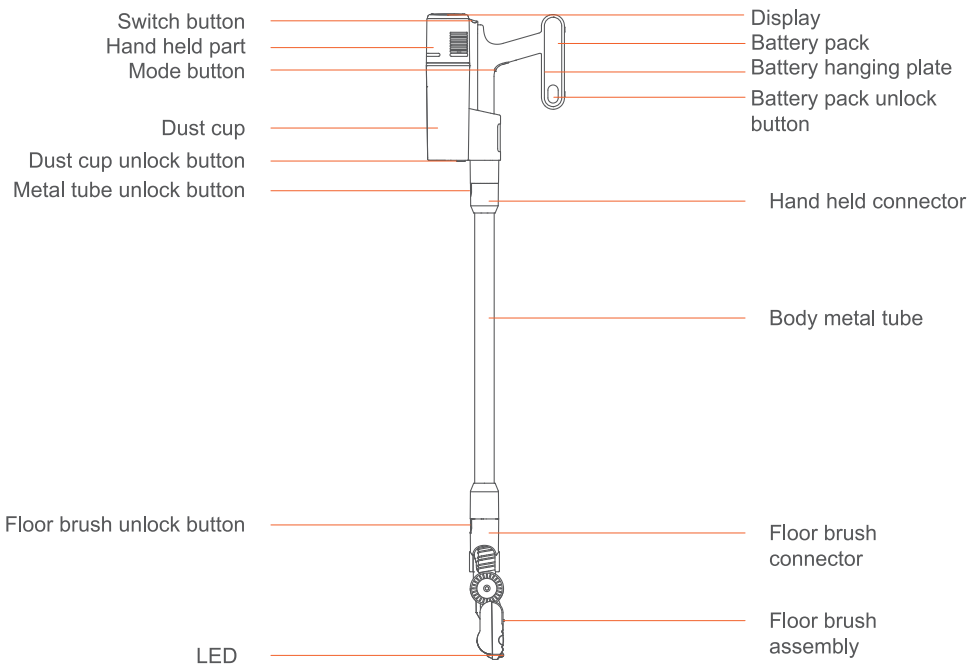

② Vacuum cleaner

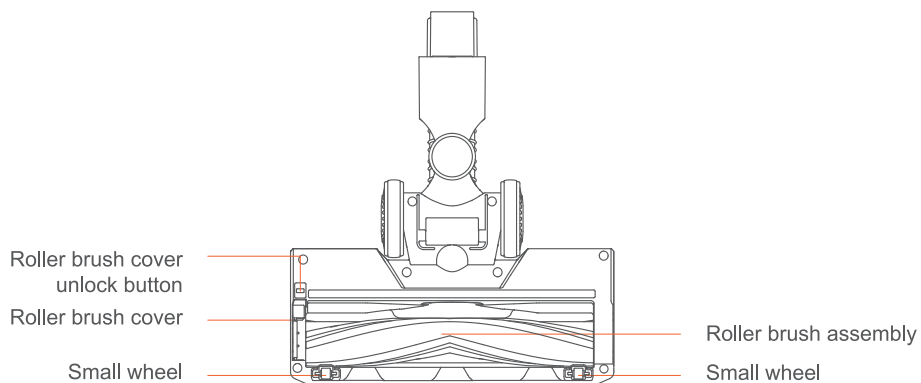

③ Floor brush assembly

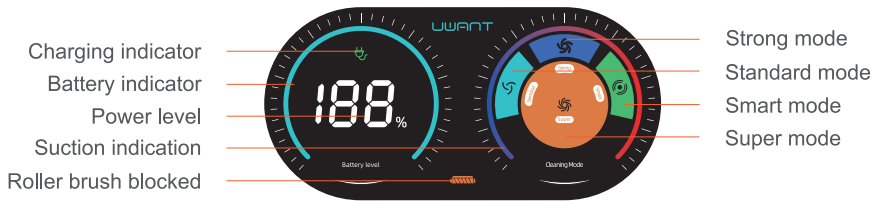

④ Display panel

III

## Instructions for Use

### Installation

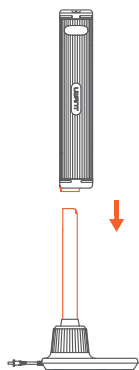

- ① When using it for the first time, locate the small holes on the dust collector and the base support rod. Align the holes and insert the dust collector into the base support rod. Press it down firmly until it reaches the bottom.

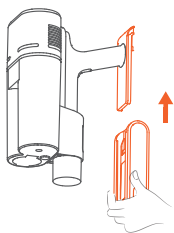

- ② Insert the battery pack into the hanging plate from bottom to top until there is a "click" sound, which indicates installation in place;

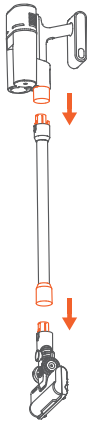

- ③ Insert the metal tube into the hand-held part, and insert the floor brush into the metal tube until there is a "click" sound, which indicates installation in place;

⚠ Note: Before first use, please check the battery power of the vacuum cleaner. If the power is insufficient, please charge it in time.



- ④ The dust bag needs to be installed before use. Push the dust bag holder upward on the dust bag lock to complete the installation.

## • First use

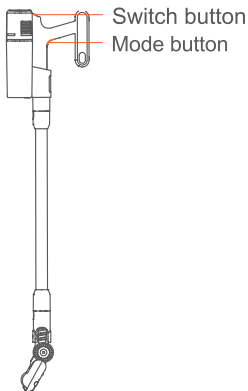

- ① Remove the vacuum cleaner from the base, press the switch button to let the machine enter the standard mode by default and start cleaning, and press the switch button again to turn off the machine;

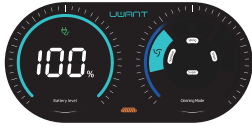

Standard mode

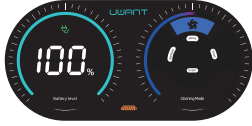

Strong mode



Smart mode



Super mode

- ② Press the mode button to switch the mode status(Standard mode/Strong mode/Smart mode/Super mode),long press the mode button to switch to super mode.

 Note: The sound of high-speed airflow generated by the vacuum cleaner is a normal phenomenon.



Battery power $\leq$ 10%

- ③ When the battery power is less than or equal to 10%, the battery indicator on the panel will be displayed in red; Battery power $\leq$ 10%

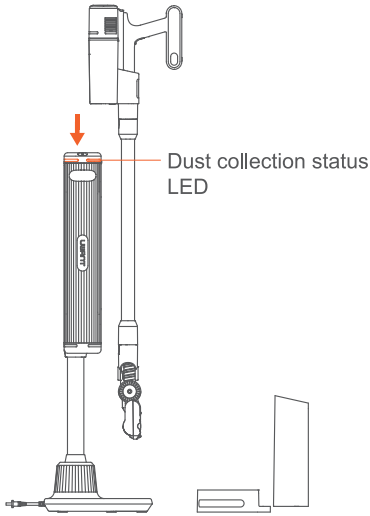

- ④ Put the vacuum cleaner in the base (powered on), align the hand-held arrow with the base arrow to automatically activate the dust collection mode (to turn off the dust collection, press the dust collection button; press it again to start dust collection); after the dust collection mode ends (dust collection LED changes from constant light to breathing light), it automatically enters the charging mode.

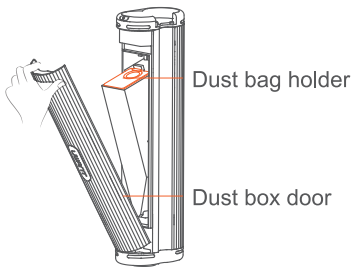

- ⑤ Open the door of the dust box, move the dust bag holder downwards, and then pull out the cardboard to take out the dust bag; install the dust bag in the reverse order.

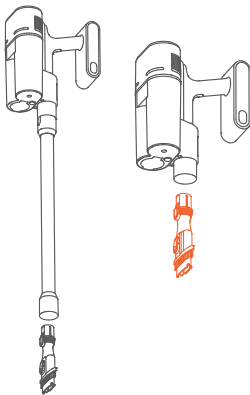

- ⑥ When cleaning windowsills, sofas or other corners, it is more efficient with the flat nozzle.

- Body cleaning

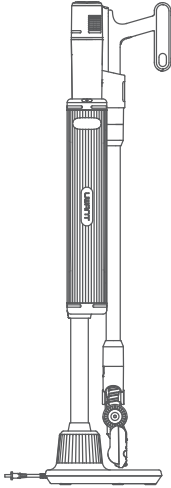

- ① Before cleaning, please make sure that the machine is turned off;

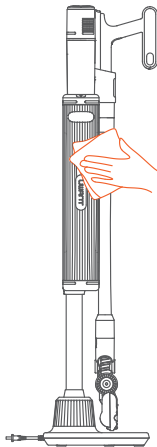

- ② Soak the cloth in water or neutral detergent, and then wipe the body after wringing. Do not let water flow into the machine.

- Clean dust cup

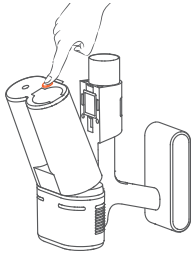

- ① Press the dust cup release button in the bottom and take out the dust cup;

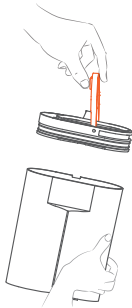

- ② Pull up the handle and take out the filter assembly from the dust cup;

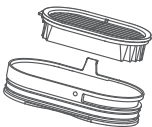

- ③ Separate the cyclone cone assembly of the filter and the air inlet HEPA;



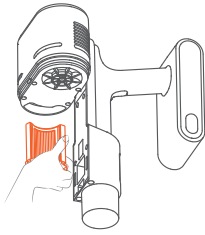

- ④ Take out the air outlet HEPA of the hand-held part;

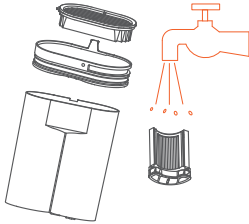

- ⑤ Rinse the dust cup, air outlet HEPA, cyclone cone assembly, and air inlet HEPA with water and dry them before putting back;

**⚠ Note:**

- Do not wash the hand-held part with water to avoid damage;
- Allow the rinsed parts to dry before putting them back to avoid damage to the product.

• **Roller brush cleaning**

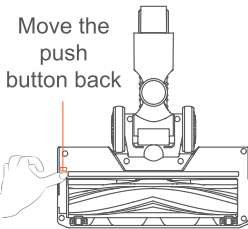

- ① Pull the roller brush cover release button backward to remove the roller brush cover;

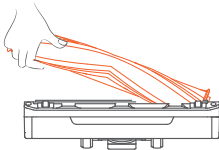

- ② Lift the roller brush from the left side;

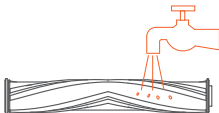

- ③ Clean, rinse and dry the roller brush and put it back again.

⚠ Warning: Be sure to dry the rinsed roller brush before putting it back on the floor brush avoid damage to the product.

⚠ Note:

- Be sure to dry the rinsed roller brush before putting it back on the floor brush to avoid damage to the product;
- Please dry the rinsed parts before putting them back to avoid damage to the product;
- When cleaning the HEPA, do not rub it violently; after washing the dust cup assembly, make sure that all parts are completely dry before placing it in the main unit;
- It is recommended to replace the HEPA every three months. It is recommended to buy the filter from official store, so as not to affect the performance of the machine;
- When cleaning the roller brush, be sure to turn off the machine to avoid personal injury;
- If the product is not used for a long time, please use the base to charge the vacuum cleaner for 3 hours every 3 months. It does not need to be fully charged to avoid battery damage.

## V

## Troubleshooting

Please check according to the table below before entrusting for service:

Fault	Probable reason	Solution
Machine not working	Battery voltage is low	Please use it after charging
Reduced suction	1. The suction port is blocked 2. HEPA is dirty 3. HEPA is not in place	1. Clean the suction port 2. Clean the dust cup and HEPA 3. Reinstall the HEPA assembly
Can't be charged	1. The power plug is loose 2. The machine is not fully inserted into the base	1. Please check whether the plug is connected well 2. Plug the machine back into the base
Roller brush blocked	The roller brush is entangled with objects such as hair	Reinstall the roller brush after cleaning

If the product still can't be used normally, please contact our company.

## VI

## Specifications

Technical parameters:

Machine name	Cordless Vacuum Cleaner
Model	V100
Rated voltage	28,8V d.c.
Battery capacity	2500mAh
Battery power	72Wh
Dust collection volume	2.5L
Charging time	≤4H

Machine name	Docking station
Model	JWV100-J-A
Ratings	230V~, 50Hz, Rated input current: 1,0A (Charge); Rated input power: 600W (Dust Collection), Rated output: 34V d.c., 0,8A;
Rated output	34V d.c., 0,8A

VII

Schematic Circuit Diagram

Main unit:

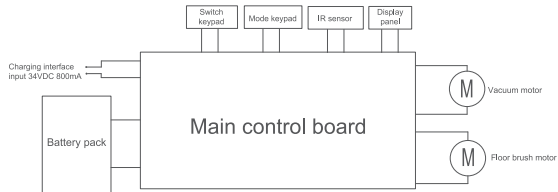

Base:

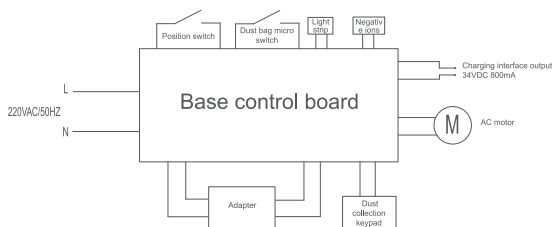

Component	Hazardous substance					
	(Pb)	(Hg)	(Cd)	(Cr(VI))	(PBB)	(PBDE)
PCBA and components	X	○	○	○	○	○
Power cord	X	○	○	○	○	○
Motor	X	○	○	○	○	○
Shell	○	○	○	○	○	○
Other accessory	○	○	○	○	○	○

This table has been prepared in accordance with the SJ/11364.

O: The content of hazardous substances in all homogeneous materials of the component is below the limit specified in GB/T26572.

X: The content of the hazardous substance in at least one of the homogeneous materials of the component exceeds the limit specified in GB/T26572.

Note: Some of the components marked with an "X" contain excessive amounts of hazardous substances due to the limited technology in the industry at present, which makes it impossible to achieve substitution or reduction for the time being.



Restricted use  
of harmful  
substance

Environment friendly use period of 10 years: Indicates the period that the harmful substances contained in this product will not leak or mutate, and no serious pollution to the environment or serious damage to personal and property will be caused when the user uses this product normally under the conditions described in the product manual;

Arrow recycling symbol: Indicates that this product can be recycled. If it exceeds the service period or fails to work properly after maintenance, it should not be discarded at will. Please hand it over to a formal recycling channel and an enterprise qualified for the disposal of waste electrical and electronic products.

## The Environment

The symbol on this appliance indicates that this appliance may not be treated as household waste. Instead it must be handed over to the applicable collection point for the recycling of electrical and electronic equipment. Disposal must be carried out in accordance with local environmental regulations for waste disposal. For more detailed information about treatment, recovery and recycling of this appliance, please contact your local city office, your household and waste disposal service or the shop where you purchased the appliance.







UWANT

---

Suzhou Jiandan Youwei Technology Co., Ltd.

Place of Origin: Suzhou, Jiangsu Province  
Address: Room 1518, Building B, Kaiping Business Center, No. 11666, East Taihu Avenue,  
East Taihu Ecological Tourism Resort (Taihu New Town), Wujiang District, Suzhou, China